

**MIPIM**/The Architectural Review

# **Future Project Awards 2018**

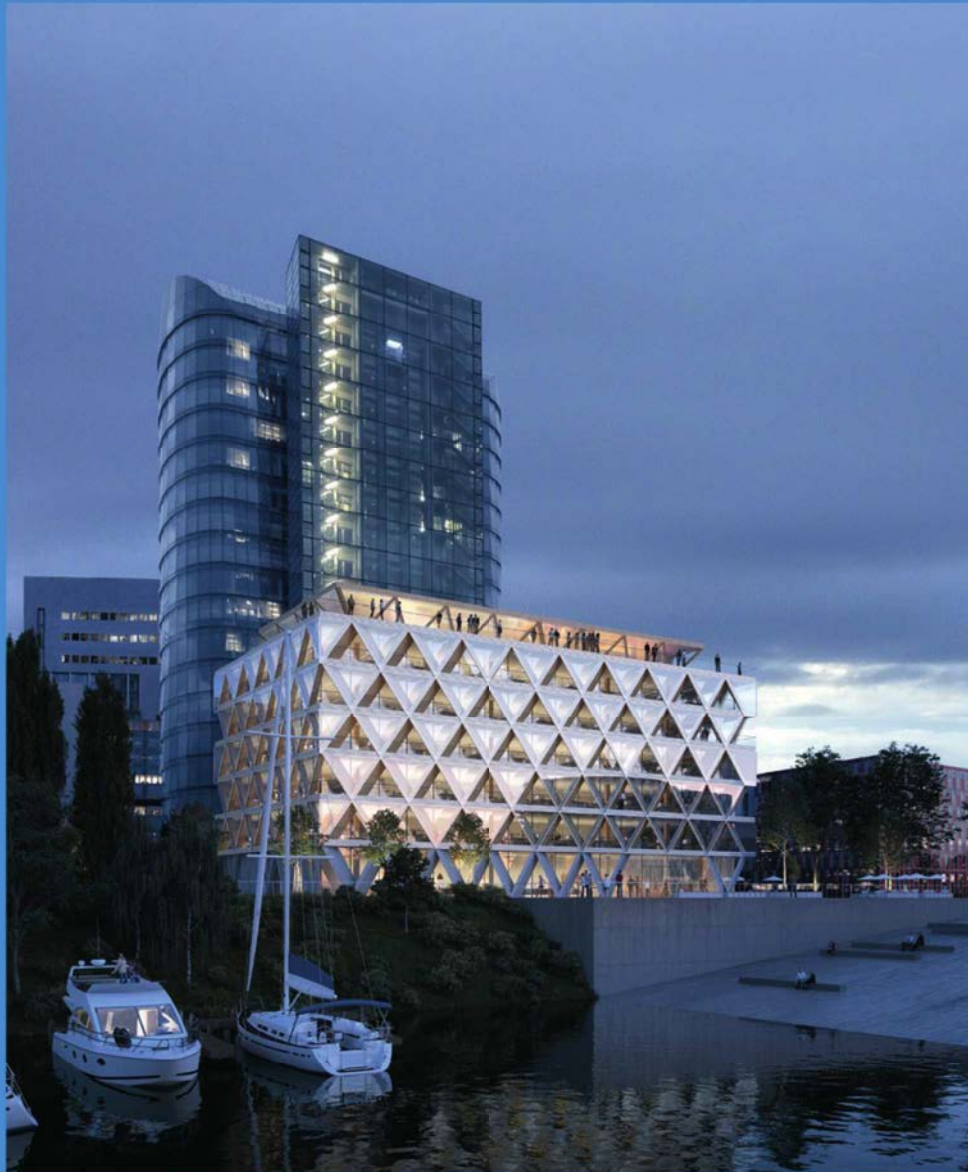

**Including the official  
MIPIM Awards**

**MIPIM**/The Architectural Review

# **Future Project Awards 2018**

**The MIPIM Architectural Review Future Project Awards, now in their 17th year, continue to provide a snapshot of what architects and clients are planning across the world. Once again, they demonstrate a rich mix of approaches and ambitions, with 281 entries (a record) from architects in more than 30 countries.**

**The 2018 awards recognise and celebrate the role of architecture in the creation of successful development, which includes the contribution made to public realm as well as the quality of proposed buildings. The trend in favour of high-density mixed-use development continues, as does the exploration of different geometries made possible by digital design tools. Sensitivity to existing contexts is a feature of the better entries – not every dense urban project relies on towers.**

**As chair of the 2018 awards jury, I would like to thank the following for their contribution to the judging process: Peter Stewart of architecture and planning consultancy PSCPA; Christina Seilern of Studio Seilern Architects; and Architectural Review contributing editor Jeremy Melvin, who also compiled the scheme descriptions.**

**We are announcing the overall winner of this year's awards at the Gala Dinner in the JW Marriott Palais Stephanie, on the evening of Wednesday 14 March.**

**Paul Finch**

Editorial Director, The Architectural Review



## Big Urban Projects Commended

‘A convincing proposition which could well be replicated across every city in the world’



### Smart Urban Park System, Graz, Austria Strohecker Architects

Smart Urban Park System is an innovative idea for urban parking to leave as much surface space for residents and reduce CO2 outputs from conventional manoeuvring. A lift meets cars on the surface and takes them underground, rotating and descending to find an empty space. When vehicle owners request their car, the process reverses. The lifts select and take the correct car to the surface. All is controlled from smart phones or watches.

‘A welcome example of landscape created above transport infrastructure, combined with ancillary commercial development’



### Kaohsiung Station, Kaohsiung, Taiwan Mecanoo Architecten For Railway Reconstruction Bureau, Pacific Engineers and Constructors

Kaohsiung’s new station is both a 21st-century transport hub, connecting train and metro, local and intercity buses, taxis and bicycles, and an updated version of the temple square in traditional Taiwanese villages with its social activity and rituals. A large canopy symbolically connects to the city and the different transport modes to each other, while providing shelter from the climate to make the plaza comfortable for people to linger and interact.